

Perfect Fit Roller Blinds

Fitting Guide

A Comprehensive Guide For Fitting Your New
Perfect Fit Roller Blinds

ORDER
BLINDS



WHAT IS NEEDED

Screwdriver

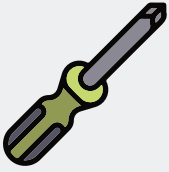

WHAT IS INCLUDED

Perfect Fit Frame + Handle Packers

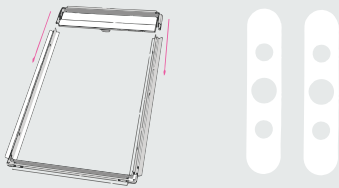

Brackets

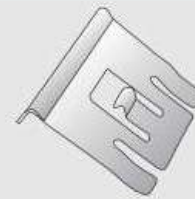

IMPORTANT INFORMATION

Be careful when opening packaging so as not to damage the fabric.

Unpack the blind and frame. Please ensure you've located the brackets before disposing of the packaging. Please also read the following instructions carefully before you start fitting your blind.

If you have any questions or need further guidance on installing your Perfect Fit Roller Blinds, please do not hesitate to contact our customer service team on 0115 9699933 or alternatively you can email info@orderblinds.co.uk.

PUT THE FRAME TOGETHER

1

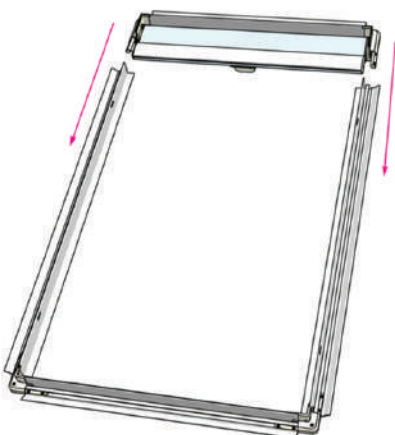

PUTTING THE FRAME TOGETHER

Slide the curved section into the body of the frame.

ATTACHING THE BRACKETS

2



To ensure all the brackets are in the correct position for fitting use the 85mm side of the fitting card for the bottom brackets. Please use 122mm side of the card for the top brackets.

For ease of insetion, use some washing up liquid on the base of each bracket.

Line the bracket with the base or top of the fitting card and fit the bracket by pushing it between the glass and the rubber seal of the window.

Repeat for all 4 corners.

FITTING THE PERFECT FIT FRAME TO THE WINDOW

3

Line up the holes in the Perfect Fit frame with the brackets, then firmly press the frame onto each bracket one side at a time. Fit one side at a time for easier installation. Once completed your frame and blind are now installed.

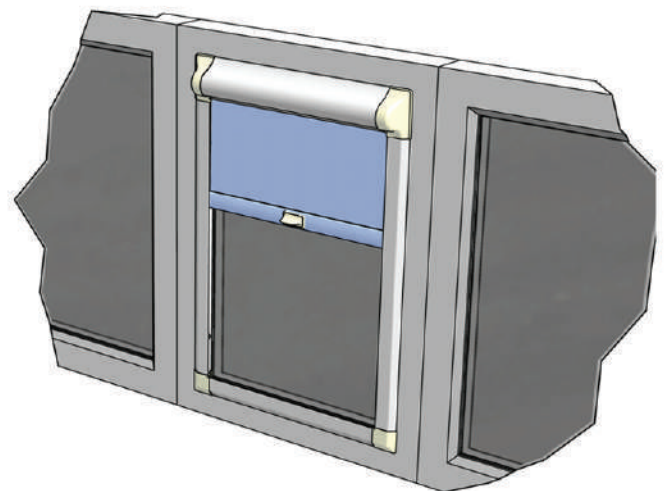
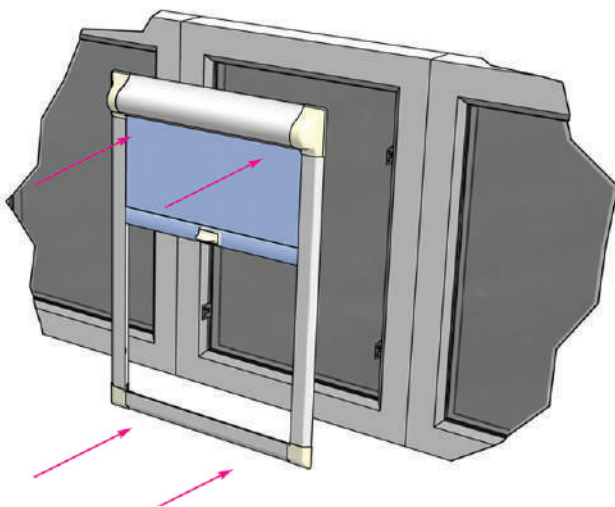

OPTION TWO

4

To fit as a bottom up Perfect Fit Blind, simply install the frame 'upside down' with the curved section at the bottom rather than at the top.

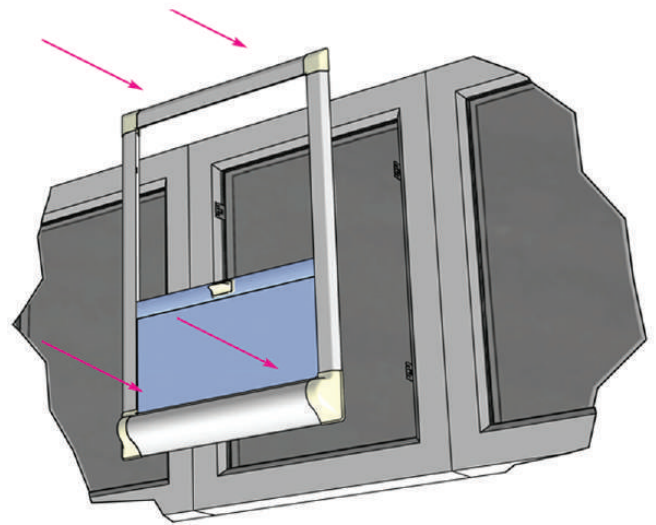

HOW TO OPERATE

5

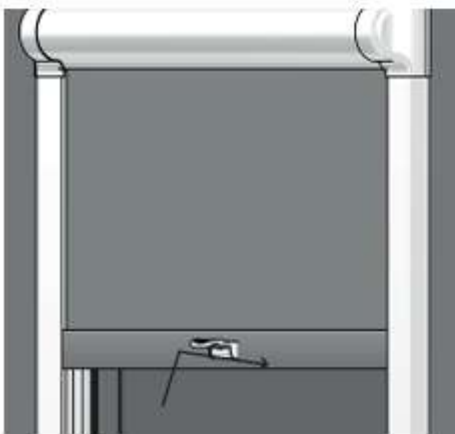

To release the blind, rock the handle forwards. The blind is then free to open and close.

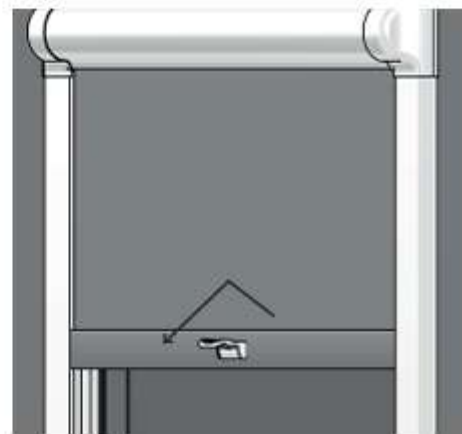

To lock the blind into position, rock the handle backwards.

HOW TO REMOVE THE BLIND

6

Return the blind to the top of the window. Remove 1 side at a time by depressing button in the bracket and sliding the frame out.

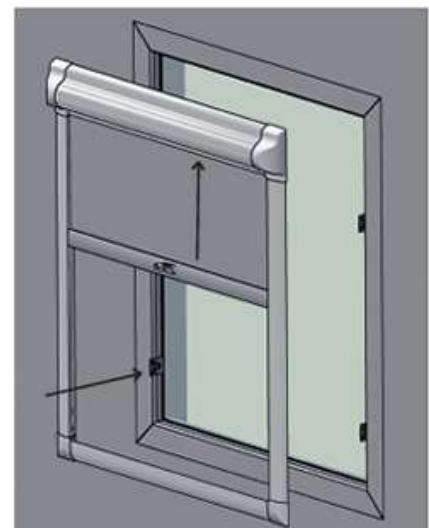

ADD / REDUCING TENSION

7

Tools needed: H4-4mm Allen Key or a T25 Torx Key.

1. Remove the framing from the window for ease of access.
2. Rotate the blind if needed so the cassette with the roller is on the top.
3. Remove the right-hand corner cover.
4. Remove the red pin and place it in a safe place as you will need to re-use it to lock the springtension.
5. Once the pin is removed, use the Allen key to adjust the tension:
 - 5.1 To add tension, rotate the allen key counterclockwise.
 - 5.2 To release tension, rotate the allen key clockwise.
6. Check tension when pulling the blind down and letting it rise on its own when unlocked. If satisfactory tension is not achieved revert to step 5). If satisfactory tension has been achieved continue to the next step.
7. Replace the red pin and the corner cover.
8. Fit the blind back on the window.
9. Enjoy the blind.

ADDITIONAL NOTES

Do not overtighten the spring or try to tension it the wrong way as that can lead to the spring inside the tube breaking. DO NOT remove the whole right-hand side mechanism from the cassette while the spring is under tension. If you have tried step 5) multiple times and the tension seems to not set, please contact us and we will try to help.



ADDITIONAL INFORMATION

8

We'd love to see how your new blinds look in your home! Share your photos with us on social media, and don't forget to tag us **@orderblinds**.

Your stylish design could be featured on our page to inspire other customers. Whether it's a bold statement or a subtle touch, your space could be the perfect inspiration for others looking to refresh their home.

Please note, our opening hours are:

Monday - 9:00am - 5:00pm

Tuesday - 9:00am - 5:00pm

Wednesday - 9:00am - 5:00pm

Thursday - 9:00am - 5:00pm

Friday - 9:00am - 3:00pm

Order Blinds Online Ltd
Newark on Trent

ORDER
BLINDS 



0115 9699933



info@orderblinds.co.uk